



**46" Square Regal Table with (3) Attached Seats, Rounded Corners - ADA Inground Mount.**

- 46" x 57" ADA Top.
- 305 Lbs.
- Top and seats are made with polyethylene coated 3/4" #9 expanded metal inside a 2" x 2" x 1/8" angle iron frame.
- Zinc coated, galvanized, powder coated, single 4" pedestal.
- With umbrella hole.
- Some assembly required.
- Insert shows actual frame style.

**Item #:** WC RSQ46ADA-3IG



**Regal Style  
Inground Mount**

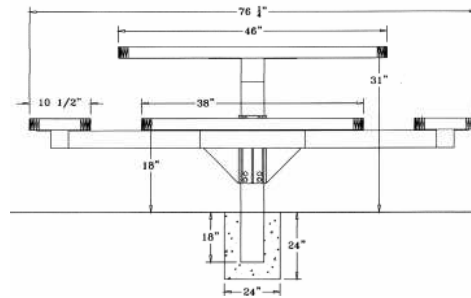

**Textured Polyethylene Colors**



**Powder Coat Gloss Finishes**

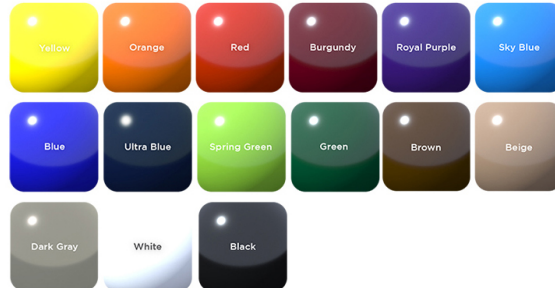

**Thermoplastic Color Options**

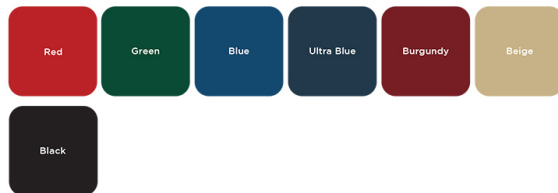

National Outdoor Furniture  
1210 W. Main Street #296  
Riverhead, N.Y. 11901

PHONE (888) 663-4621  
E-MAIL [nofinc1@gmail.com](mailto:nofinc1@gmail.com)

[www.nationaloutdoorfurniture.com](http://www.nationaloutdoorfurniture.com)