



**6' and 8' Heavy Duty Aluminum Picnic Table - Portable.**

- 131 - 170 Lbs.
- 6' Overall Dimensions: 72"L x 62"W x 30"H.
- Frame available in 1 5/8" and 2 3/8" O.D. pipe with 1 5/16" O.D. brace.
- All MIG welded frame with zinc or galvanized plated hardware.
- Pre-drilled holes for surface mounting frame.
- Zinc coated, galvanized, powder coated or galvanized legs.
- Without umbrella hole.
- Available in 2" x 10" aluminum planks.
- Some assembly required.

**Item #:** US 158-A

**Standard Powder Coat Colors**

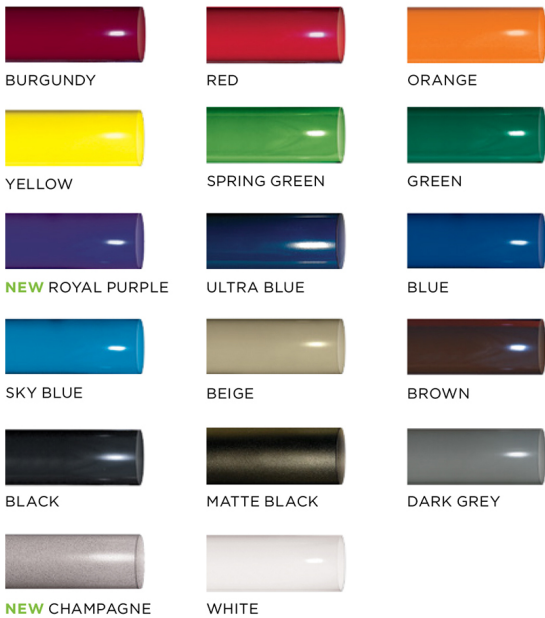

Model Number	Description
US 158PA-A6	6' Table, 1 5/8" O.D. Pipe, Aluminum Planks, Portable.
US 238PA-A6	6' Table, 2 3/8" O.D. Pipe, Aluminum Planks, Portable.
US 158PA-A8	8' Table, 1 5/8" O.D. Pipe, Aluminum Planks, Portable.
US 238PA-A8	8' Table, 2 3/8" O.D. Pipe, Aluminum Planks, Portable.



National Outdoor Furniture  
1210 W. Main Street #296  
Riverhead, N.Y. 11901

PHONE (888) 663-4621  
E-MAIL [nofinc1@gmail.com](mailto:nofinc1@gmail.com)

[www.nationaloutdoorfurniture.com](http://www.nationaloutdoorfurniture.com)

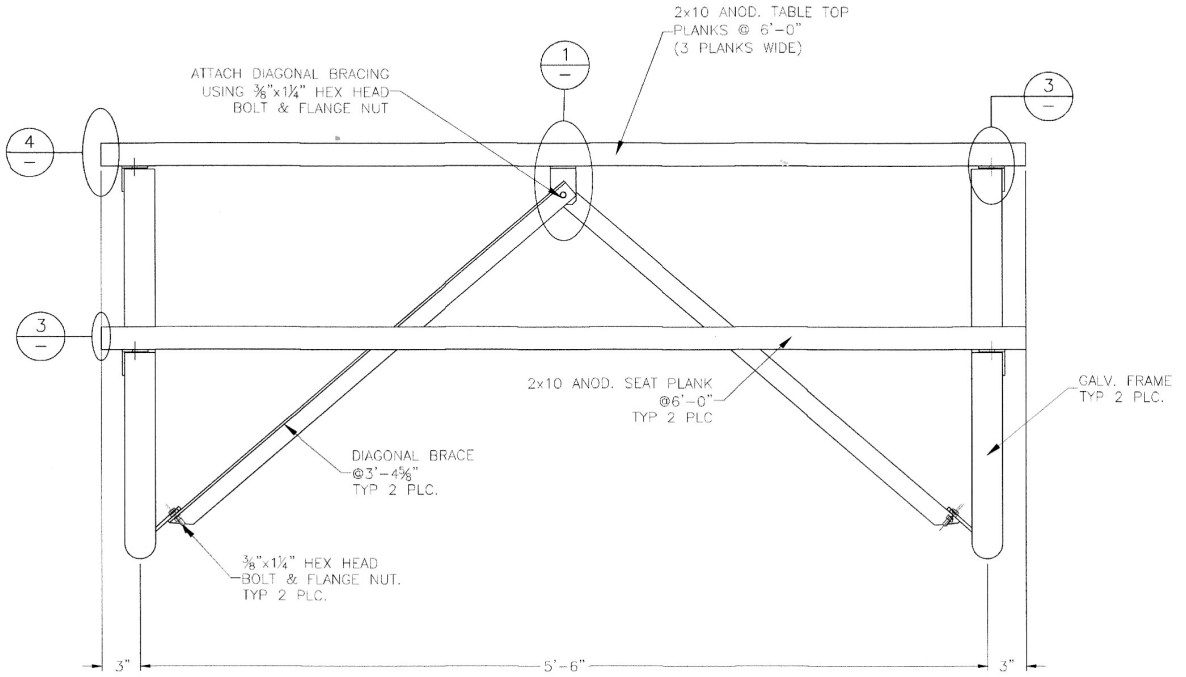
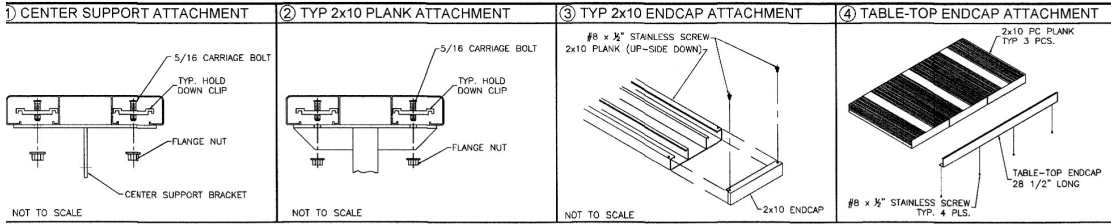

National Outdoor Furniture  
1210 W. Main Street #296  
Riverhead, N.Y. 11901

PHONE (888) 663-4621  
E-MAIL [nofinc1@gmail.com](mailto:nofinc1@gmail.com)

[www.nationaloutdoorfurniture.com](http://www.nationaloutdoorfurniture.com)